

# Installation Guide

To best achieve maximum thermal value and to ensure the quickest and simplest installation of Foilboard® GREEN rigid insulation panel to stud wall systems, Foilboard® Insulation Systems recommend the following methods.

## Resi 1

## Brick Veneer (timber frame / steel frame)

### Required to install.



Use Foilboard® Standard Fasteners (timber frame) for the Foilboard® GREEN 10 & GREEN 15.

Use Ultra Fasteners for Foilboard® GREEN 20 & GREEN 25.

OR



Use Foilboard® TEK Fasteners (steel frame) for the Foilboard® GREEN 10 & GREEN 15 & TEK

Use Ultra Fasteners for Foilboard® GREEN 20 & GREEN 25.

AND



Foilboard Green PVC joining tape.

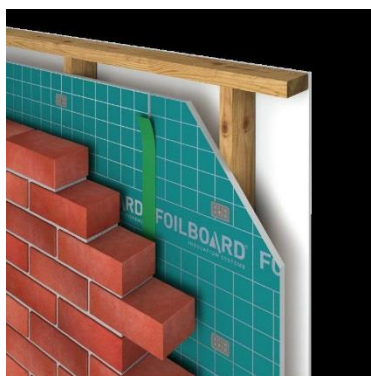

Simple step by step guide to installing Foilboard® GREEN rigid insulation.

### STEP 1

Install the Foilboard® GREEN rigid insulation panel to the external face of the studwork, ensuring the anti-glare side is facing out, measure the area you require.



### STEP 2

Mark the measurements out on the Foilboard® GREEN rigid insulation panel, using the gridlines (registered design) as a guide, then using a straight edge and a sharp blade / knife, cut the rigid panel to size



You can also check out our installation videos guide online at - [foilboard.com.au](http://foilboard.com.au)



Foilboard Fred

# Installation Guide

Resi 1

Brick Veneer (timber frame / steel frame)

## Recommendations & Tips

- ✓ Best to install Foilboard® after the studwork and roughing in services are completed but prior to electrical services
- ✓ In windy conditions, start on the windward side of the building first
- ✓ Start with area that can use full sheets (saving time and unnecessary cutting)
- ✓ Start from the top of the build and work down
- ✓ Ensure the Foilboard® panel properly covers the top and bottom plate
- ✓ Panels don't need to join over studs
- ✓ Fill in remaining sections with smaller off-cuts, this will help minimise wastage

### STEP 3

Position the sheets against the steel / timber frame, ensuring that the panels butt hard up to any doors, windows and the underside of the roof truss.



### STEP 4

Fasten the insulation panel to the studwork with the Foilboard® Fasteners using approx. 5-6 per m<sup>2</sup>. Use either a hammer or drill. (depending on the fasteners required)



### STEP 5

Tape all penetrations, joints and gaps using the Foilboard® green PVC tape, ensuring the stop of cold / hot air transfer.



In need of a further technical advice or assistance?  
Foilboard® Technical Department is available to assist

**1800 354 717**